



**KRS Series**



**KRA**



**Plug**

**Class I, Div. 1 & 2, Groups C,D<sup>①</sup>**  
**Class I, Zones 1 & 2, IIB,IIA**  
**NEMA 7 (C,D)**

Listed File No. E23572

Certified File No. LR14667

**FEATURES-SPECIFICATIONS**

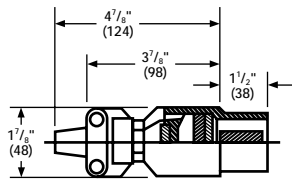

KP 20 AMP PLUG	
CATALOG NO.	DESCRIPTION
KP-20A	Plug furnished with 3 grommets range .250 - .625

See page PR20 for available polarization options.

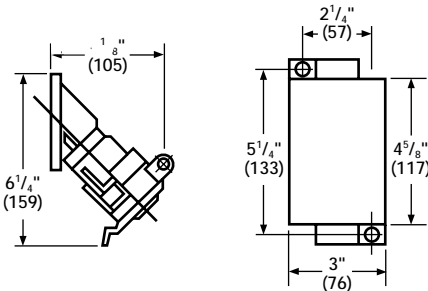

**KRS-Series**

KRS 20A 1Ø 2W 3Ø RECEPTACLE WITH SWB BOX <sup>②</sup>								
HUB SIZE	CATALOG NUMBER							
	SINGLE RECEPTACLE & DEAD END BOX	BOX ONLY	SINGLE RECEPTACLE & FEED-THRU BOX	BOX ONLY	DOUBLE RECEPTACLE & DEAD END BOX	BOX ONLY	DOUBLE RECEPTACLE & FEED-THRU BOX	BOX ONLY
1/2"	KRS-215-120	SWB-1	KRS-218-120	SWB-4	2KRS-215-120	SWB-7	2KRS-218-120	SWB-10
3/4"	KRS-215-220	SWB-2	KRS-218-220	SWB-5	2KRS-215-220	SWB-8	2KRS-218-220	SWB-11
1"	KRS-215-320	SWB-3	KRS-218-320	SWB-6	2KRS-215-320	SWB-9	2KRS-218-320	SWB-12

RECEPTACLE ONLY - CATALOG NUMBER KRS-20

<sup>①</sup> KRS Series receptacles - Class I, Group D.

<sup>②</sup> SWB Series mounting splice boxes only for receptacles shown above listed on page C29.

See page PR20 for available polarization options.

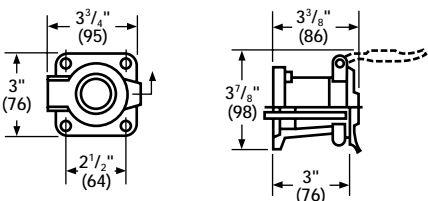

**KRJ-Series**



**AJC**



**JLC**



**JLX**

KRJ RECEPTACLE WITH AJ OR JL BOX			
HUB SIZE	CATALOG NUMBER		
	AJC	JLC	JLX
1/2"	—	KRJJC-120	KRJX-120
3/4"	KRAJC-220	KRJJC-220	KRJX-220
1"	KRAJC-320	—	—

BACK BOX ONLY			
1/2"	—	JLC-1	JLX-1
3/4"	AJC-2	JLC-2	JLX-2
1"	AJC-3	—	—

RECEPTACLE ONLY - CATALOG NUMBER KRJ-20

ELECTRICAL RATING	
CIRCUIT	RATING (60 HERTZ)
1Ø 2W3P	20 AMPS 115/230 V.A.C. 1 H.P.



**KILLARK®**

JL Series boxes shown on page F62. Refer to page headings for suitability of specific items.

See page PR20 for available polarization options.

### KRS/KRJ SERIES PLUG



KRS Series



KRA Series



Plug

Class I, Div. 1 & 2, Groups C,D<sup>Ⓛ</sup>  
Class I, Zones 1 & 2, IIB, IIA  
NEMA 7 (C,D)

Listed - File E23572  
See files for details or call Killark.

### FEATURES-SPECIFICATIONS

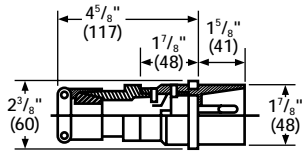

D Type

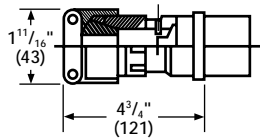

E Type

KP 30 AMP PLUG			
CATALOG NUMBER		PLUG TYPE	GROMMET RANGE
1Ø, 2-WIRE, 3-POLE	3Ø, 3-WIRE 4-POLE		
KP-303D23	KP-304D23	D	.375-.625
KP-303D45	KP-304D45	D	.625-.875
KP-303E45	KP-304E45	E	.875-1.125
KP-303E67	KP-304E67	E	1.125-1.375

See page PR20 for available polarization options.

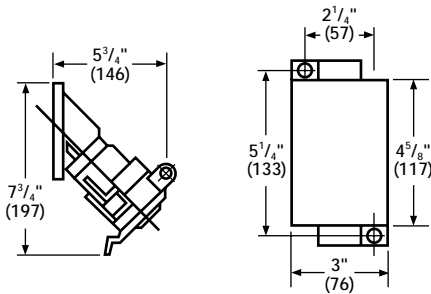

KRS-Series

KRS RECEPTACLE WITH SWB BOX <sup>Ⓛ</sup>							
HUB SIZE	CATALOG NUMBER - SINGLE GANG ONLY						
	1Ø, 2-WIRE, 3-POLE DEAD END BOX	BOX ONLY	1Ø, 2-WIRE, 3-POLE FEED THRU BOX	BOX ONLY	3Ø, 3-WIRE, 4-POLE DEAD END BOX	BOX ONLY	3Ø, 3-WIRE, 4-POLE FEED THRU BOX
1/2"	KRS-215-1303	SWB-1	KRS-218-1303	SWB-4	KRS-215-1304	SWB-1	KRS-218-1304
3/4"	KRS-215-2303	SWB-2	KRS-218-2303	SWB-5	KRS-215-2304	SWB-2	KRS-218-2304
1"	KRS-215-3303	SWB-3	KRS-218-3303	SWB-6	KRS-215-3304	SWB-3	KRS-218-3304
RECEPTACLE ONLY	KRS-303			KRS-304			

<sup>Ⓛ</sup> KRS Series receptacles - Class I, Group D.

<sup>Ⓛ</sup> SWB Series mounting splice boxes for receptacles shown above listed on page C29. Two gang models not available.

See page PR20 for available polarization options.

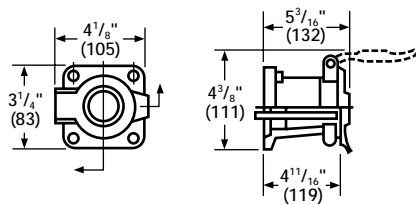

KRJ-Series

ELECTRICAL RATING	
CIRCUIT	RATING (60 HERTZ)
1 Ø	7 Amps 460 V.A.C. 1/2 H.P.
2-Wire	- OR -
3-Pole	30 Amps 115/230 V.A.C. 1-1/2 H.P.
3 Ø	7 Amps 460 V.A.C. 1 H.P.
3-Wire	- OR -
4-Pole	30 Amps 115/230 V.A.C. 3 H.P.



AJC



JLC



JLX

KRJ RECEPTACLE WITH AJ OR JL BOX				
CIRCUIT	HUB SIZE	CATALOG NUMBER		
		AJC	JLC	JLX
1Ø 2-Wire 3-Pole	1/2"	—	KRJC-1303	KRJC-1303
	3/4"	KRAJC-2303	KRJC-2303	KRJC-2303
	1"	KRAJC-3303	—	—
RECEPTACLE ONLY- CATALOG NUMBER KRJ-303				
3Ø 3-Wire 4-Pole	1/2"	—	KRJC-1304	KRJC-1304
	3/4"	KRAJC-2304	KRJC-2304	KRJC-2304
	1"	KRAJC-3304	—	—
RECEPTACLE ONLY- CATALOG NUMBER KRJ-304				
Back Box Only	1/2"	—	JLC-1	JLC-1
	3/4"	AJC-2	JLC-2	JLC-2
	1"	AJC-3	—	—

JL Series boxes shown on page F61. Refer to page headings for suitability of specific items.

See page PR20 for available polarization options.





**Class I, Div. 1 & 2, Groups C,D**  
**Class I, Zones 1 & 2, IIB,IIA**  
**NEMA 7 (C,D)**

Listed File No. E23572

**FEATURES-SPECIFICATIONS**

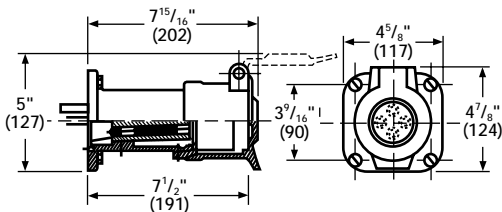

**KRJ-60 Type Receptacles**

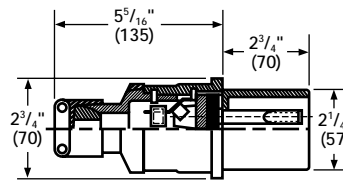

**KP Type Plugs**

KR 60 AMP PLUGS		
CATALOG NUMBER		GROMMET RANGE
1Ø, 2-WIRE, 3-POLE	3Ø, 3-WIRE 4-POLE	
KP-603D345	KP-604D345	.500-.875
KP-603E45	KP-604E45	.875-1.125
KP-603E67	KP-604E67	1.125-1.375
—	KP-604F34	1.250-1.500
—	KP-604F56	1.500-1.750

See page PR20 for available polarization options.

**Dimensions-Back Boxes**

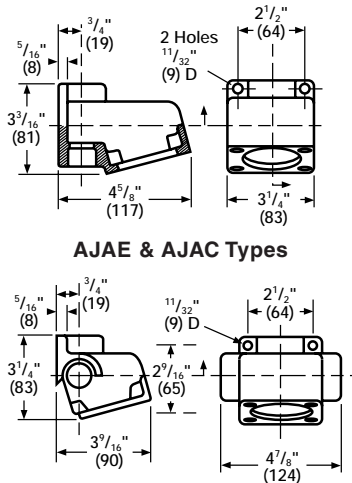

**AJAT Type**

KR RECEPTACLE ASSEMBLIES					
HUB SIZE	BOX STYLE	HUB STYLE	CATALOG NUMBER		
			1Ø, 2-WIRE 3-POLE	3Ø, 3-WIRE 4-POLE	SPLICE BOX ONLY
1"	JAL Series Boxes	"X"-3 Close-up Plugs Supplied	KRJX-3603	KRJX-3604	JALX-3
1-1/4"			KRJX-4603	KRJX-4604	JALX-4
1-1/4"	AJA Series Boxes	Feed Thru Top and Bottom	KRAJAC-4603	KRAJAC-4604	AJAC-4
1-1/2"			KRAJAC-5603	KRAJAC-5604	AJAC-5
2"			KRAJAC-6603	KRAJAC-6604	AJAC-6
1-1/4"		T Sides and Top	KRAJAT-4603	KRAJAT-4604	AJAT-4
1-1/2"			KRAJAT-5603	KRAJAT-5604	AJAT-5
RECEPTACLE ONLY			KRJ-603	KRJ-604	—

NOTE: For dead end box, use AJAC Series and CUP Series close-up plug.

See page PR20 for available polarization options.

ELECTRICAL RATING	
CIRCUIT	RATING (60 HERTZ)
1 Ø	30 Amps 460 V.A.C. 3 H.P.
2-Wire 3-Pole	— OR —
	60 Amps 115/230 V.A.C. 3 H.P.
3 Ø	30 Amps 460 V.A.C. 5 H.P.
3-Wire 4-Pole	— OR —
	60 Amps 115/230 V.A.C. 5 H.P.

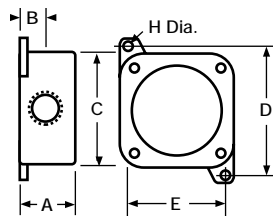

**JAL Type**

JAL TYPE MOUNTING BOXES						
HUB	A	B	C	D	E	H
1"	2-3/8"	1-5/32"	4-5/8"	5-1/4"	4-1/8"	5/16"
1-1/4"	3-1/8"	1-17/32"	4-5/8"	5-1/4"	4-1/8"	5/16"